

GROHE

45.158

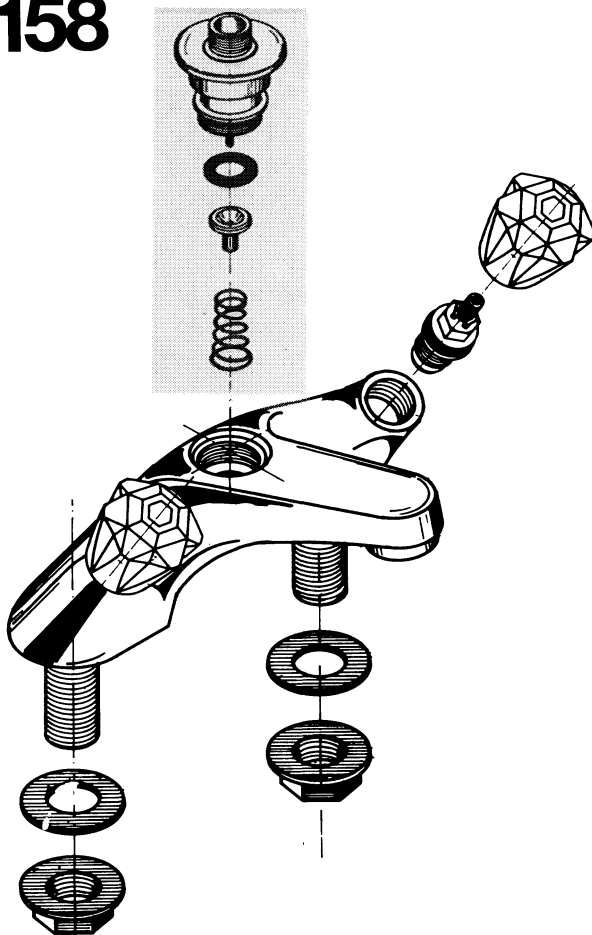

CATALOGUE DESCRIPTION	C. P. push ring in line diverter mechanism for C. P. brass Pillar and Deck type bath shower mixers.
DISMANTLING & REASSEMBLY	<ol style="list-style-type: none"> 1. Unscrew shower attachment. 2. Unscrew diverter assembly which should be hand tight. 3. Remove washer plate assembly and spring from body. 4. Reassemble in reverse order.
SERVICING	<p>DIVERTER WILL NOT HOLD IN SHOWER POSITION.</p> <p>a) Insufficient head of water (pressure) e.g. Flomatic installation. Change spring 04 018 to light spring 04 388 see diagram.</p> <p>b) Obstruction – foreign matter in mechanism or wear on diverter washer. Dismantle and clean or replace where necessary see above.</p> <p>WATER EMANATES FROM NOZZLE AND SHOWER AT THE SAME TIME Obstruction – foreign matter in mechanism or wear on diverter washer. Dismantle and clean or replace where necessary see above.</p>