

## STEEL 19

Washplace, wall-hung, glazed steel, shelf right, with overflow, including fixing set, drain valve with open/closed function, bottle trap, bottle trap cover, glass shelf, wall outlet fitting in splashback, with pre-assembled concealed valve



### DIMENSIONS

Length	1000 mm
Width	490 mm
Height	590 mm

### COLOUR AND FINISH

000 White

### OPTIONS

109 - without tap hole

Asymmetrical

Back glazed

Bowl length (mm) : 1000

Bowl position : Left

Bowl width (mm) : 497

Fixing kit : Included

Glazed base

Installation type : Wall-hung

Integrated shelf

Internal Shape : 1 - Round

Material : Glazed steel

Net weight (kg) : 44

Overflow type : Standard

Plug and Waste : Included

Shape : Rectangular

Taphole configuration : No tapholes

Trap : Included

Waste : Included

Weight (Kg) : 33

## TECHNICAL DRAWINGS

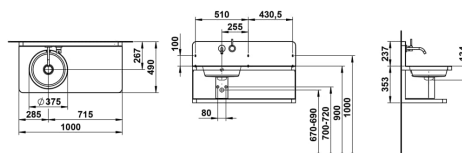



## STEEL 19

Steel19 – Where Design Meets  
Functionality to Create True Innovation

Steel19 is a thoughtfully designed complete concept for modern bathroom design—clear in its design, high-quality in execution, and versatile in application. The combination of glazed steel and a precisely crafted matte black metal frame creates a distinctive wash area with strong graphic presence. The backsplash, basin, and faucet form a harmonious unit that impresses both functionally and aesthetically.

Steel19 stands for modern bathroom design with character: for those who seek something special—people who find perfection in simplicity.

