

INSERT

Washplace, wall-hung, glazed steel, with one tap hole, right, without overflow, including fixing set, drain valve



DIMENSIONS

| | |
|--------|--------|
| Length | 355 mm |
| Width | 350 mm |
| Height | 470 mm |

COLOUR AND FINISH

| | |
|--------------------------|-----------|
| <input type="checkbox"/> | 000 White |
|--------------------------|-----------|

OPTIONS

111 - one tap hole, without overflow

Back glazed

Bowl length (mm) : 355

Bowl position : Central

Bowl width (mm) : 350

Corner basin

Fixing kit : Included

Glazed base

Installation type : Wall-hung

Internal Shape : 1 - Round

Material : Glazed steel

Net weight (kg) : 7.35

Overflow type : Standard

Plug and Waste : Included

Shape : Rectangular

Tap hole configuration : No tap holes

Trap : Included

Waste : Included

Weight (Kg) : 7.35

Without overflow

TECHNICAL DRAWINGS

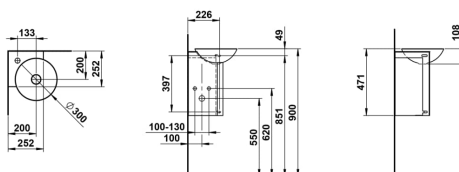

INSERT

Small Bathrooms Demand Smart Solutions – With INSERT, Even the Smallest Space Becomes a Stylish Oasis

INSERT combines compact elegance with thoughtful functionality. High-quality materials and precise craftsmanship ensure lasting beauty that gives every room character and personality.

